

Runs your business smoothly.

This A4 colour all-in-one multifunctional laser printer is designed specifically for medium and large-sized work groups, offering both reliability and fast output speeds in both colour and monochrome.

Key features of this device:

- Efficiency, reliability and low running cost - through it's long-life components
- Energy saver - low power consumption
- Powerful customisation feature - enabled with HyPAS[™] solution platform
- Searchable PDF and Scan to MS Office with optional Scan Extension Kit

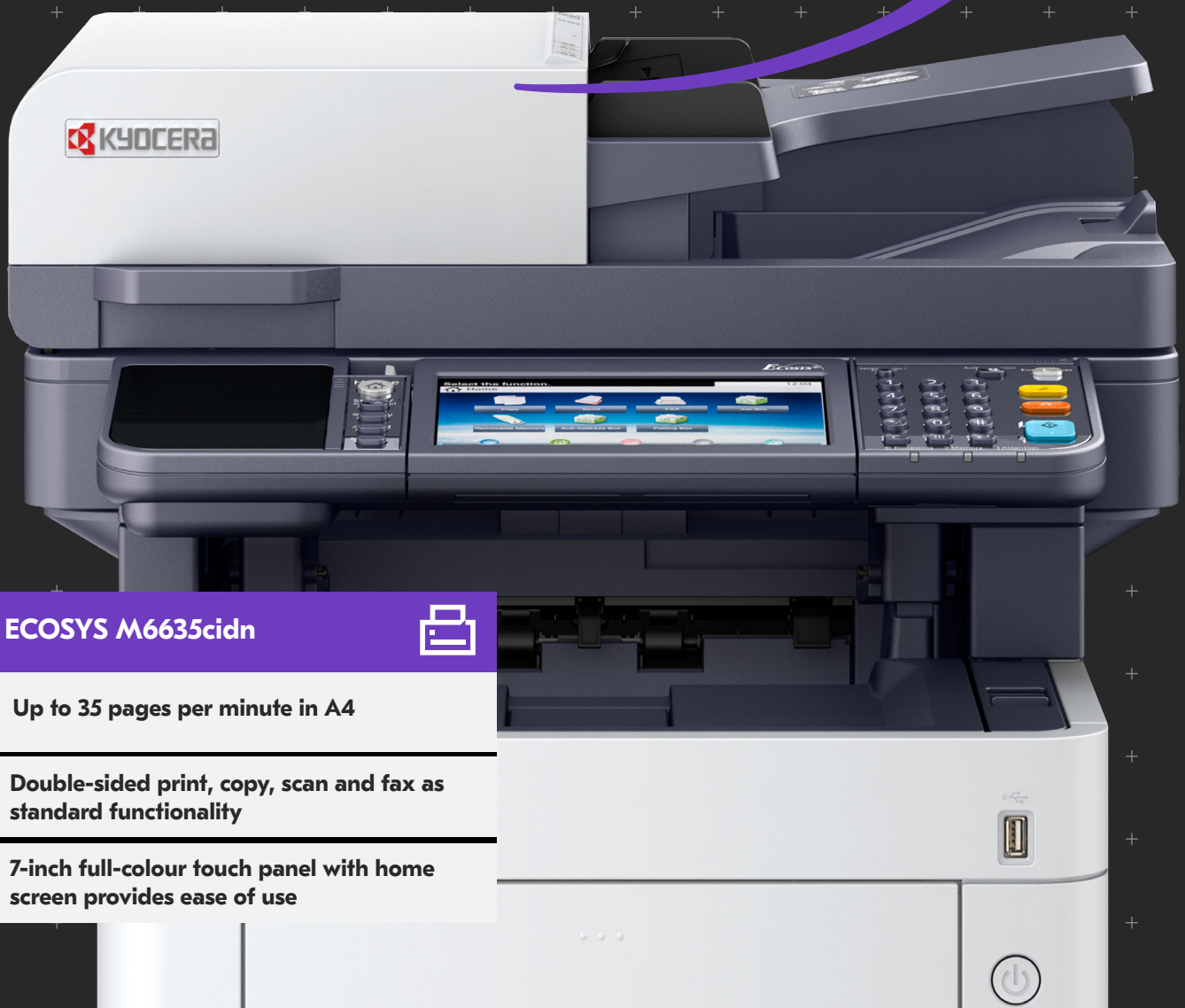

ECOSYS M6635cidn



Up to 35 pages per minute in A4

Double-sided print, copy, scan and fax as standard functionality

7-inch full-colour touch panel with home screen provides ease of use

Specifications

ECOSYS

The ECOSYS M6635cidn incorporate extremely durable components that guarantee efficient and reliable operation, to meet the demanding requirements of busy office environments. They combine effective productivity and maximum flexibility whilst ensuring minimum impact on the environment.

GENERAL

Technology: KYOCERA ECOSYS, Laser, Colour, HyPAS™ solution platform

Operation panel: 177.8 mm (7 inch) full-colour touch panel display, speaker for job notification, 10° - 20° swivel mounted

Type: Desktop

Engine speed: Up to 35 pages A4 per minute

Duplex print speed: 17 page per minute, A4

Duplex copy speed: 17 page per minute, A4

Resolution: 1200 x 1200 dpi (print, at reduced speed), 600 x 600 dpi (scan/copy)

Warm-up time: Approx. 25 seconds or less

Time to first print: Approx. 8.5/10 seconds or less in b/w / colour

Time to first copy: Approx. 8.5/10 seconds or less in b/w / colour (DP), Approx. 7.5/8.5 seconds or less in b/w / colour (Platen Cover)

CPU: ARM Cortex-A9 Dual core 1.2GHz + ARM Cortex-M3 100MHz

Memory: Standard 1GB, Max. 3GB + 128GB SSD
Standard interface: USB 2.0 (Hi-Speed), 2 x USB Host Interface, Gigabit Ethernet (10BaseT/100BaseTX/1000BaseT, IPv6, IPv4, IPSec, 802.3az support), optional Wi-Fi (IEEE 802.11b/g/n), 1 eSATA slot for optional internal server, Slot for optional SD Card

Integrated accounting: 100 department codes

Dimensions (W x D x H): 480 x 577 x 619.5 mm

Weight: Approx. 36.5 kg

Power source: AC 220 ~ 240 V, 50Hz

Power consumption

Printing: 532 W

Copying: 547 W

Low power mode: -- W

Ready mode: 84 W

Sleep-mode: 0.6 W

Noise (sound pressure level): ISO 7779/ISO 9296)

Copying/Printing: 52 dB (A)

Stand-by: 30 dB (A)

Safety standards: AS/NZS3260

This unit is manufactured according to ISO 9001 quality standard and ISO 14001 environmental standard.

PAPER HANDLING

All paper capacities quoted are based on paper thickness of max. 0.11 mm. Please use paper recommended by KYOCERA under normal environmental conditions.

Input capacity:

100-sheet multi-purpose tray, 60–220g/m², A4, A5, A6, B5, B6, Letter, Legal, Folio, Custom (70 x 148 to 216 x 356 mm), 250-sheet Standard universal paper cassette, 60–163 g/m², A4, A5, A6, B5, B6, Letter, Legal, Folio, Custom (105 x 148 – 216 x 356 mm). Max. input capacity with options: 1,850 sheets A4

Duplex unit: Duplex as standard supports 60–163 g/m², A4, A5, B5, Letter, Legal

Dual scan document processor: standard, 100 sheets, 50–120 g/m², A4, A5, A6, B5, Letter, Legal, Custom (105 x 148 to 216 x 356 mm)

Output capacity: Max. 250 sheets face-down with paper full sensor

PRINT FUNCTIONS

Controller language: PRESCRIBE II c

Emulations: PCL6 (5c/XL), KPDL3 (PostScript 3 compatible), PDF Direct Print, XPS Direct Print

Operating systems: All current Windows operating systems, MAC OS X Version 10.8 or higher, Unix, Linux as well as other operating systems on request

Fonts/barcodes: 93 outline fonts (PCL), 93 fonts (KPDL 3), 8 fonts (Windows Vista), 1 Bitmap font, 45 types of onedimensional barcodes, 1 type of two-dimensional barcode (PDF417)

Print features: Encrypted PDF Direct Print, IPP printing, e-mail printing, WSD print, secure printing via SSL, IPsec, SNMPv3, quick copy, proof and hold, private print, job storage and job management functionality

Mobile printing support: KYOCERA Mobile Print app for iOS and Android, AirPrint, Mopria, Direct Wi-Fi, Google cloud print

COPY FUNCTIONS

Max. original size: A4/Legal

Continuous copying: 1–999

Zoom range: 25–400% in 1% steps

Pre-set magnification ratios: 5 Reductions / 5 Enlargements

Exposure mode: Auto, manual: 9 steps

Image adjustments: Text + Photo, Photo, Text, Map, Printed document

Features: Scan-once-copy-many, electronic sort (collate), ID card copy, Zint, 4in1, auto cassette change, Skip blank page

SCAN FUNCTIONS

Functionality: Scan-to-Email, Scan-to-FTP, Scan-to-SMB, Scan to USB Host, Local/Network TWAIN, WIA, WSD scan

Scan speed: 62 ipm (300 dpi, A4, b/w), 46 ipm (300 dpi, A4 colour), 46 ipm (300 dpi, A4, b/w), 32 ipm (300 dpi, A4 colour)

Scan resolution: 600, 400, 300, 200 dpi, 256 greyscales per colour

Max. scan size: A4, Legal

Original recognition: Text, photo, text + photo, light text, optimised for OCR

File types: TIFF, PDF, PDF/A, JPEG, XPS, Open XPS, Encrypted PDF, High compression PDF, PDF/A-1a/b, PDF/A-2a/b/u, MS Office file and Searchable PDF (optional Scan Extension Kit(A) is required)

Compression method: MMR/JPEG

Features: Colour scan, integrated address book, Active Directory support, encrypted data transfer, multi send (e-mail, fax, SMB/FTP folder, print) at once, Blank page skip

FAX FUNCTIONS

Compatibility: ITU-T Super G3

Modem speed: Max. 33.6 kbps

Transmission speed: Max. 3 seconds (JBIG)

Scanning speed: 2.0 seconds or less

Address book: 200 entries

Scanning density:

Normal: 8 dot/mm x 3.85 line/mm (200 x 100 dpi)

Fine: 8 dot/mm x 7.7 line/mm (200 x 200 dpi)

Superfine: 8 dot/mm x 15.4 line/mm (200 x 400 dpi)

Ultrafine: 16 dot/mm x 15.4 line/mm (400 x 400 dpi)

Half-tone: 256 grey scales

Maximum original size: A4/Legal

Compression method: JBIG, MMR, MR, MH

Memory reception: 256 sheets or more

Features: Network fax, duplex transmission and reception, encrypted transmission and reception, polling transmission and reception, broadcast

CONSUMABLES

Average continuous toner yield in accordance ISO/IEC 19798

TK-5284K Toner Kit: Micro fine black for 13,000 pages A4

TK-5284C, TK-5284M, TK-5284Y Toner Kits: Micro fine toner cyan, magenta, yellow for 11,000 pages A4. Capacity of starter toner is black 6,000 pages, cyan, magenta, yellow 5,000 pages A4

OPTIONS

Scan Extension Kit (A): Scan to searchable PDF (embedded OCR) or to MS Office (docx, xlsx, pptx)

Paper handling

PF-5100 Paper feeder (max 3 units): 500 sheets, 60–220 g/m², A4, A5, B5, Letter, Legal, Custom (92 x 162 mm to 216 x 356 mm)

HD-6 SSD: 32 GB for easy document management

HD-7 SSD: 128 GB for easy document management

Data Security Kit (E): In line with ISO 15408 (Common Criteria) with security level EAL2

Memory upgrade: 512MB/1GB/2GB

UG-33: ThinPrint support

USB IC Card Reader + Card Authentication Kit (B): Support for various authentication keys available

IC Card Reader Holder 10: To integrate the USB IC Card

Optional interface:

IB-36: Direct Wi-Fi Interface

IB-50: Gigabit-Ethernet board 10 BaseT/100 BaseTX/ 1,000 BaseT

IB-51: Wireless LAN Interface (802.11b/g/n)

1277: Cabinet

What's more, the ECOSYS 6635cidn dedicated program keys and KYOCERA's open solution platform HyPAS can help further optimize your document workflow. And helping your costs go down, this machine ensures excellent running costs.



KYOCERA Document Solutions Australia

Ph: 13 59 62

www.kyoceradocumentsolutions.com.au

KYOCERA Document Solutions New Zealand

Ph: 0800 459 623

www.kyoceradocumentsolutions.co.nz



kyoceradocumentsolutions.com.au

Kyocera Document Solutions does not warrant that any specifications mentioned will be error-free. Specifications are subject to change without notice. Information is correct at time of going to press. All other brand and product names may be registered trademarks or trademarks of their respective holders and are hereby acknowledged.

KYOCERA Document Solutions Australia Pty. Ltd ABN 77 003 852 444